

# The CELL RANGER® installs in 4 easy steps!

## NOTE:

The Cell Ranger® can be used in most locations with any device featuring a USB port. The following installation procedures are written for using the Port with a laptop. The same procedures can be followed for any device with a USB port that you choose to use the Cell Ranger with. No software or drivers are required for the Cell Ranger Port.

## STEP 1:

Carefully remove Antenna and cable from package.

## STEP 2: LAPTOP INSTALLATION

Place the magnetic mount Antenna in a location 10 or more feet away from the Port. Optimal placement is outside a window if using the Port in a Home or Office setting (fig. A) or if you are not close to an exterior window, try several locations around the room to find the best signal strength (fig. B). Position the Antenna as far away as possible from the USB port. If using the Port while traveling in your vehicle best antenna placement is on the roof or trunk of the vehicle (fig C).

Fig. A

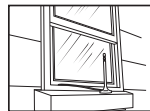

Out the window

Fig. B

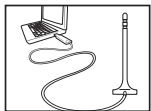

Within the room

Fig. C

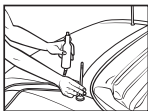

Vehicle

**NOTE: When placing the Antenna outside of a window, it is preferable to put it on a metal surface for best clarity.**

Be careful closing a window on the cable not to cause damage.

## STEP 3: ROUTING THE CABLE

For Portable Install: if you are going to be taking the CELL RANGER® as you travel to different locations, run the cable so that it is out of the way but is not under desks or behind furniture etc. This will allow you to easily remove the cable as needed.

For Permanent Install: if you are going to leave the CELL RANGER® at this location you will want to secure the cable so it is out of the way and less likely to be snagged by people moving around the room. You can route the cable behind your desk and any furniture in the room. The Antenna can now be fed to the exterior window or to the location in the room you have chosen for the antenna.

## STEP 4:

After the Antenna is securely mounted and the cable is properly routed you are now ready to plug the CELL RANGER® into the USB port on your laptop.

Check the signal bars on your cell phone or wireless air card before plugging in the CELL RANGER®. Plug the CELL RANGER® into the USB port on your laptop (fig. D). The green light on the CELL RANGER® should be lit. Place your cell phone a few inches from the CELL RANGER® and check the signal bars on your phone again. Within 30 seconds you should see an increase in the bars and signal level.

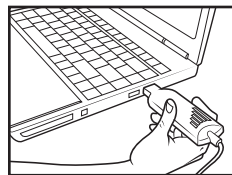

Fig. D

You are now ready to use your portable communications device(s) with CELL RANGER® Enhanced Performance!

## IMPORTANT

For Support call 1-877-275-5016 or visit our website at [www.cellranger.net](http://www.cellranger.net) with any technical questions or for more information on our products.

**CAUTION:** Periodic removal of the Cell Ranger® antenna from metal surfaces for cleaning and maintenance is advised to ensure optimum performance, and prevention of possible discoloration of the metal surface.

If used in a vehicle Cell Ranger® is not responsible for any damage to the vehicle's exterior if the antenna is left in place indefinitely.

The CELL RANGER® is a fast, easy and low cost way to improve the performance of your portable communications device. Using the CELL RANGER® Port will increase network and download speed over air cards, and will allow you to receive service in areas with low signal levels.

The CELL RANGER® does not need a signal, but improves it, so if you are in an area without a signal this product may not operate.

#### WARNINGS

The CELL RANGER® Model 08811960B complies with FCC regulations. Follow all guidelines and read this information completely before installing the system. Never operate the system in an unintended application.

- All portable communications devices in the vicinity of the amplifier should be turned off when installing the system. Only after unit is installed should portable communications devices be turned on and tested with the system.
- Make sure to connect to a 12-Volt source that is not providing power when the vehicle is turned off or unplug 12V adapter, otherwise battery will drain.
- Only the antenna provided with the CELL RANGER system may be used. Use of any other antenna could adversely affect the performance of the system and cause damage to the unit, voiding the warranty.
- Changes or modifications not expressly approved by MoGo Wireless INC. may void the user's authority to operate the equipment.

#### ELECTRONIC SPECIFICATIONS

Frequency:	869-894, 1930-1990 MHz
Gain:	48 dB typ.
Output Power:	10 dBm typ.
Supply:	5 Volts DC @ 0.250 amps
Operating Temp:	-30 to +60
Size:	5" x 1.5" x 0.9"
Weight:	0.3 Lbs.

#### FCC REGULATIONS – FCC ID: U408811960B IC-ID: 7041A-8811960B

The MoGo Wireless Inc. © CELL RANGER has been tested and found to comply with the limits of FCC rules part 22 for mobile service and part 24 for PCS. These limits are designed to provide reasonable protection against harmful interference. This equipment generates, uses and can radiate radio frequency energy and if not installed and used in accordance with this instruction manual, may cause harmful interference to radio communications. However, there is no guarantee that interference will not occur in a particular installation. If this equipment does cause harmful interference to radio or other electronic reception, which can be determined by turning the equipment off and on, the user is encouraged to correct the interference by one or more of the following measures:

- Reposition or relocate the receiving antenna
- Increase the distance between the equipment and the receiver
- Connect to isolated power with a ground cable attached directly to the battery, DC source or house ground
- Repositioning the coaxial cable may also eliminate interference
- Consult the dealer or an experienced electronics technician for assistance

**WARNING: Changes or modifications not expressly approved by MoGo Wireless Inc. may void the user's authority to operate the equipment.**

#### LIMITED WARRANTY

The CELL RANGER by MoGo Wireless Inc. warrants to the purchaser for a period of ninety (90) days from the date of purchase, but in no event longer than one (1) year from the date of manufacture, that its Products identified above under Package Contents and sold hereunder will at the time of shipment be free from defects in material and workmanship and will conform to MoGo Wireless Inc. specifications stated in this Manual. If products sold hereunder are not as warranted, MoGo Wireless Inc. shall, at its option, repair or replace the Product; provided that: 1) proof of purchase (a copy of a valid receipt or invoice) and written notice of the alleged defect are received by MoGo Wireless Inc. within the warranty period stated above; 2) customer obtains a written Return Authorization from MoGo Wireless Inc. for the Product; 3) the Product is returned in a protected shipping container at customer's expense; and 4) MoGo Wireless Inc. determines that the Product does not meet the warranty stated herein. If MoGo Wireless Inc. determines that the Product does not meet the warranty, MoGo Wireless Inc. will pay for transporting the repaired or exchanged Product to the customer. This warranty shall not apply to any MoGo Wireless Inc. determines to have been, by customer or otherwise, subject to mishandling, misuse, neglect, improper testing, repair, alteration, damage, assembly or processing that alters the physical or electrical properties. As the above Products depend on the existence of a sufficient signal to enhance, MoGo Wireless Inc. cannot and does not warrant that the Products will work in all locations. In addition, MoGo Wireless Inc. does not warrant that interference will not occur in a particular installation.

**THIS LIMITED WARRANTY IS EXPRESSLY IN LIEU OF AND EXCLUDES ALL OTHER WARRANTIES, EXPRESS AND/OR IMPLIED INCLUDING BUT NOT LIMITED TO WARRANTIES OF MERCHANTABILITY, AND OF FITNESS FOR A PARTICULAR PURPOSE, USE OR APPLICATION AND FOR ALL OTHER OBLIGATIONS OR LIABILITIES ON THE PART OF THE SELLER, UNLESS SUCH OTHER WARRANTIES, OBLIGATIONS OR LIABILITIES ARE EXPRESSLY AGREED TO IN WRITING BY MOGO WIRELESS INC. 2007 MOGO WIRELESS INC.  
© 2008 CELL RANGER®**

# CELLRANGER®

## BOOST YOUR BARS!



Wireless Dual band Cellular / PCS Amplifier

OWNERS MANUAL